

**SolidWorks Student Edition.  
For Academic Use Only.**

	Approval	Date	Comments	Description	Catapult Arm
CTO				Dwg. No.	14C-00
CEO				Sheet 1 of 4	4/7/2014 11:27:49 AM

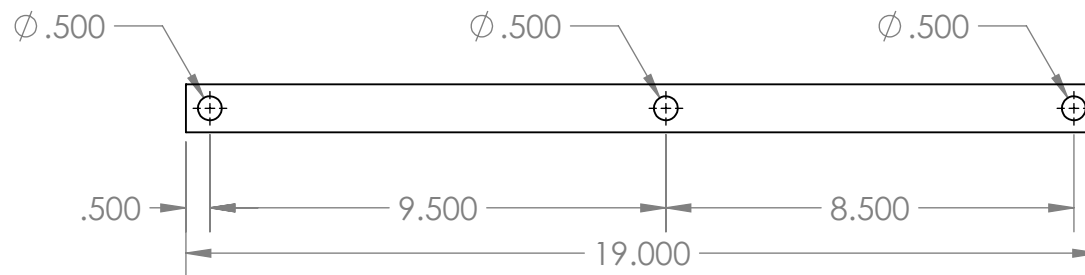

14C-00-00	Qty 2
1x1x1/8 Tubing	

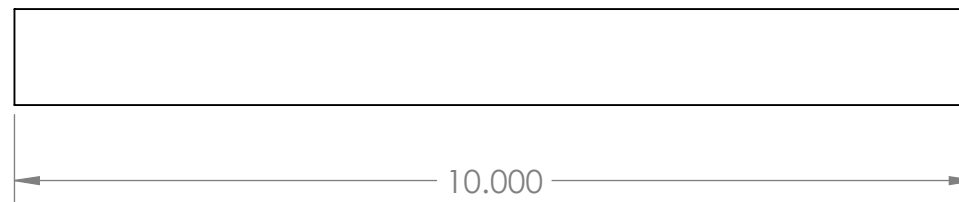

14C-00-01	Qty 1
1x1x1/8 Tubing	

14C-00-05	Qty 2
2x1/8 Plate	

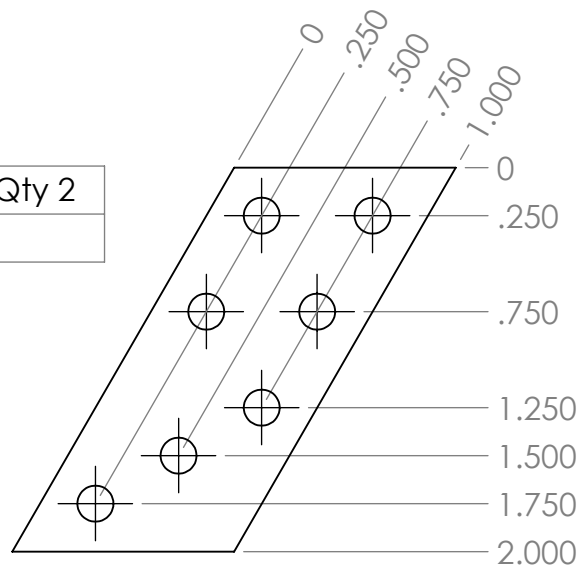

14C-00-06	Qty 4
4x1/8 Plate	

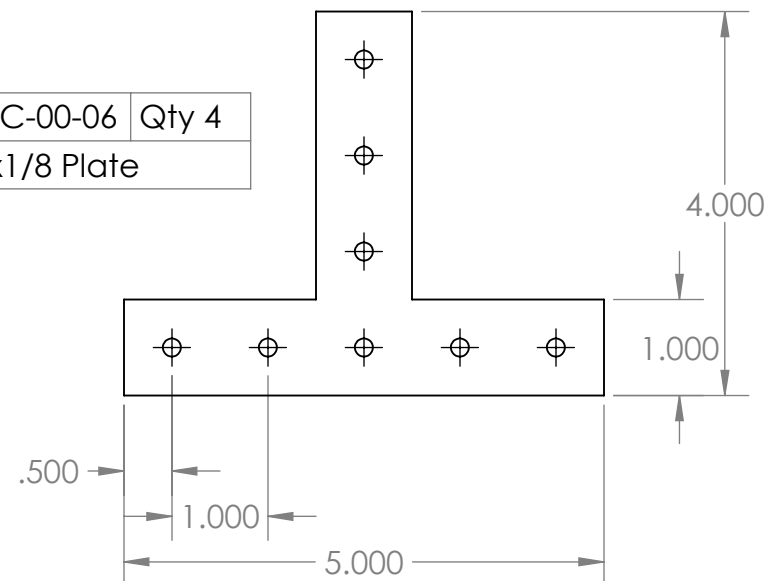

**SolidWorks Student Edition.  
For Academic Use Only.**

	Approval	Date	Comments	Description	Parts
CTO			All holes 3/16 unless otherwise noted	Dwg. No.	14C-00
CEO				Sheet 2 of 4	4/7/2014 11:27:49 AM

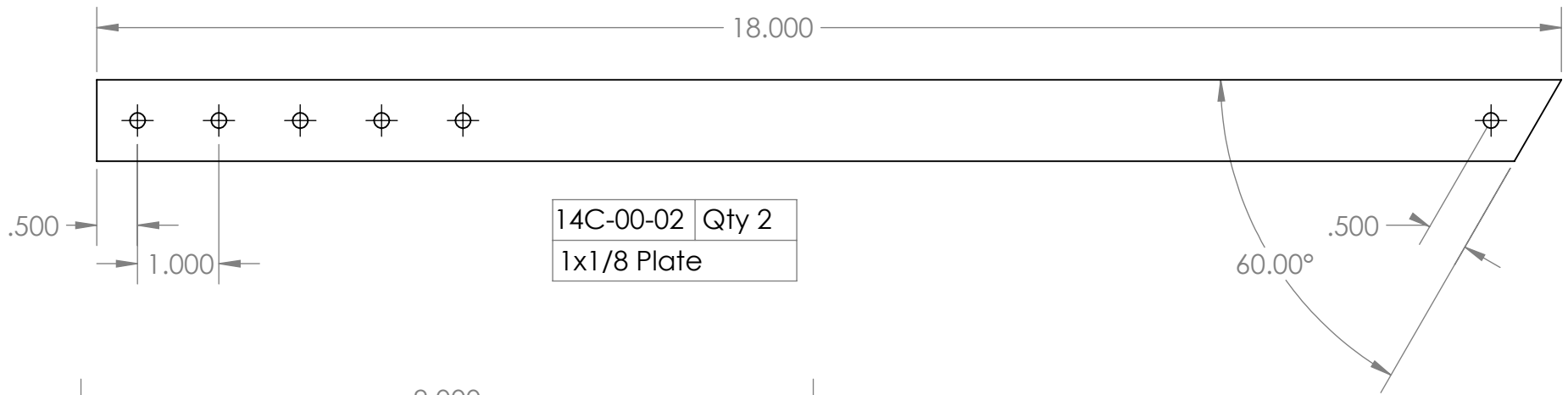

14C-00-02	Qty 2
1x1/8 Plate	

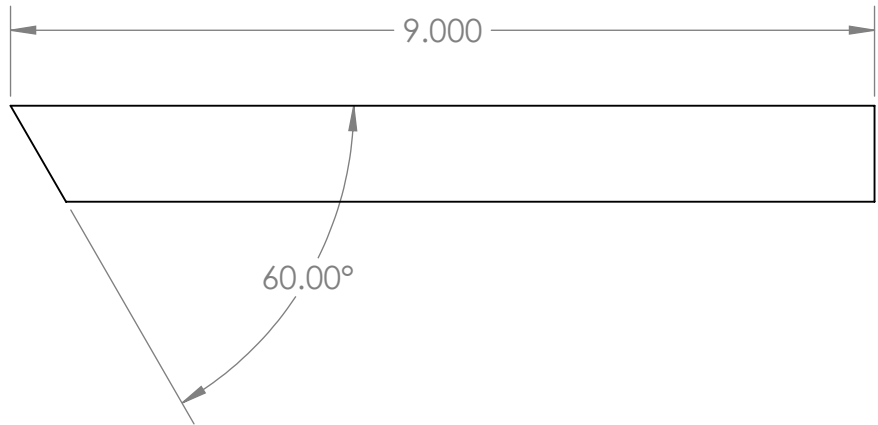

14C-00-03	Qty 2
1x1/8 Plate	

14C-00-04	Qty 4
0.5 Steel Shaft	

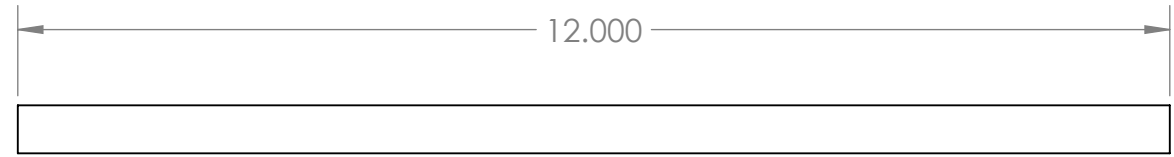

**SolidWorks Student Edition.  
For Academic Use Only.**

	Approval	Date	Comments All holes 3/16 unless otherwise noted	Description	Parts
CTO				Dwg. No.	14C-00
CEO				Sheet 3 of 4	4/7/2014 11:27:49 AM

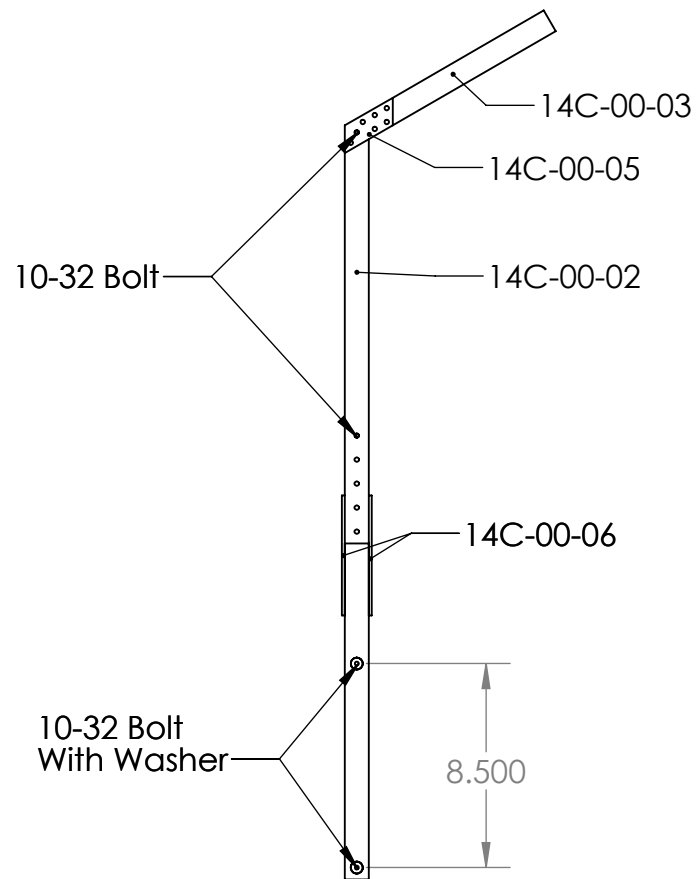
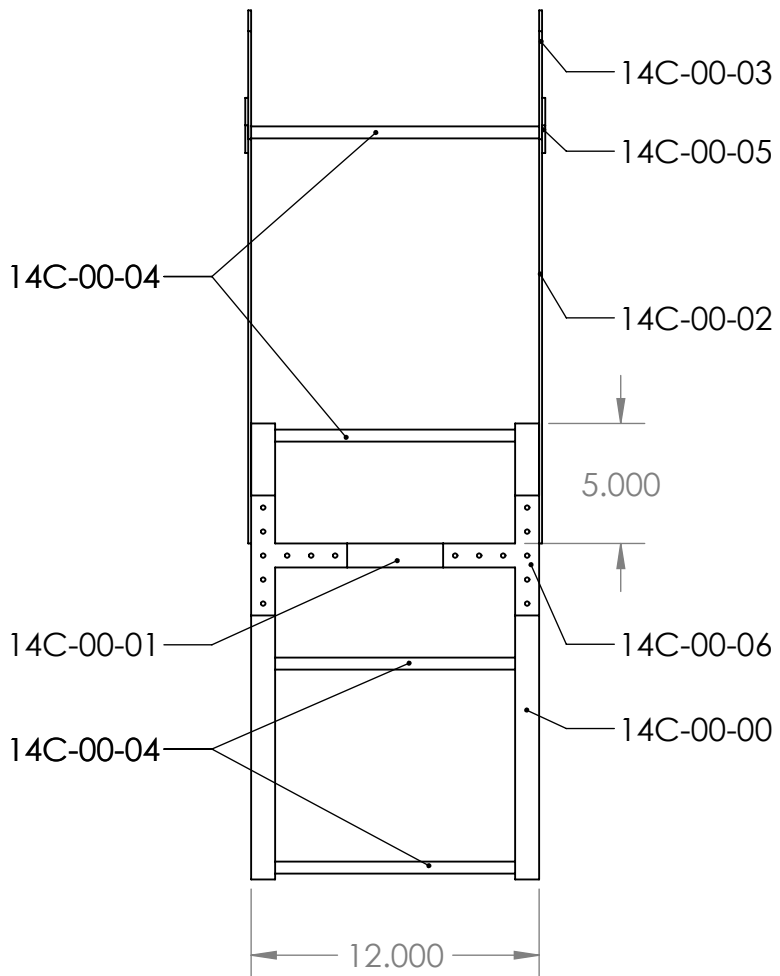

**SolidWorks Student Edition.  
For Academic Use Only.**

	Approval	Date	Comments	Description	Description
CTO				Dwg. No.	14C-00
CEO				Sheet 4 of 4	4/7/2014 11:27:49 AM